

GLASS MERCHANDISER WITH OVAL BASE

Item # WDGLOV(F)

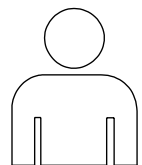
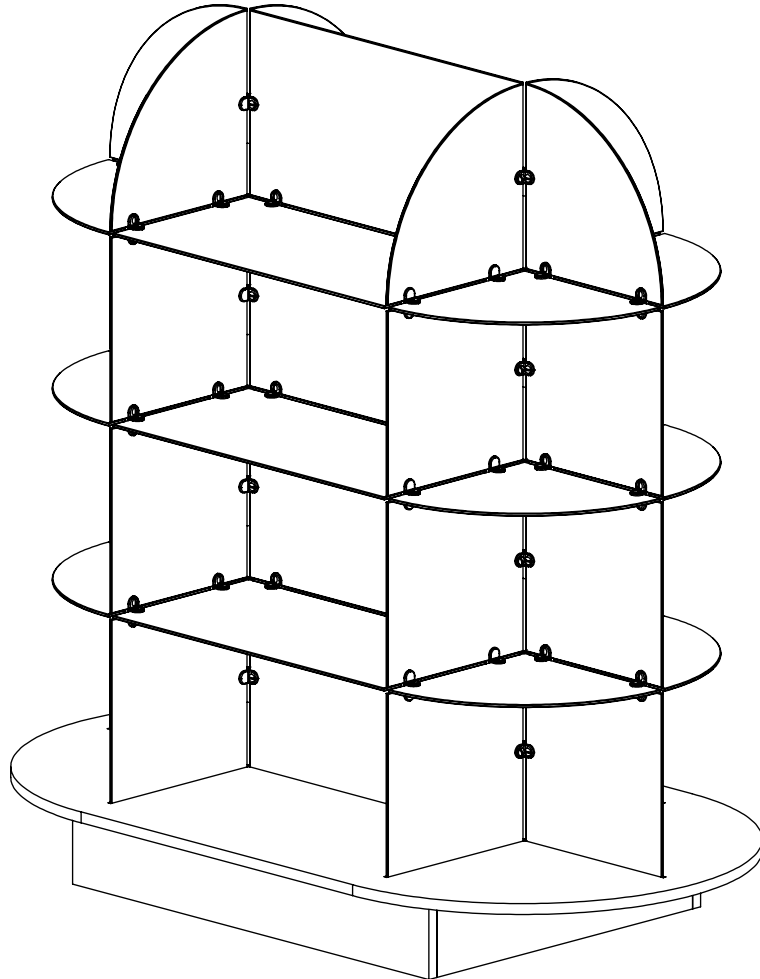

**2 PEOPLE
REQUIRED
FOR
ASSEMBLY**

INCLUDED HARDWARE



18X
CAM LOCK NUT



18X
CAM LOCK STEM

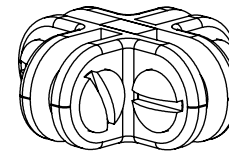

52X
4-WAY CONNECTOR

TOOLS REQUIRED

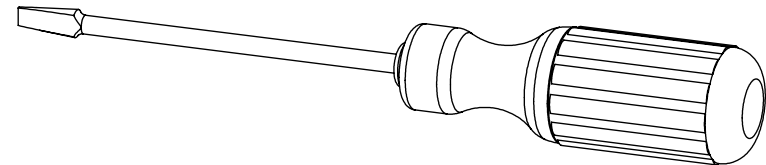

FLAT HEAD SCREWDRIVER

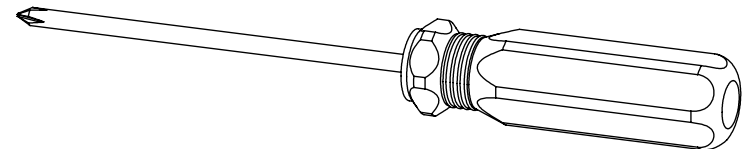

PHILLIPS HEAD SCREWDRIVER

1A

- THREAD (8) OF THE CAM LOCK STEMS INTO THE THREADED INSERTS ON THE LONG LENGTHS OF THE BASE AS SHOWN WITH A PHILLIPS HEAD SCREWDRIVER.

NOTE: DO NOT OVERTIGHTEN.

- JOIN THE BASE PIECES TOGETHER AS SHOWN.

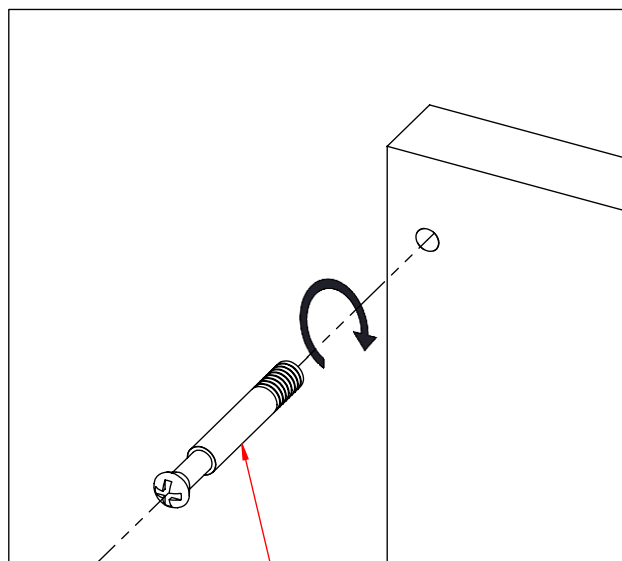

CAM LOCK
STEM

THREADED STEMS

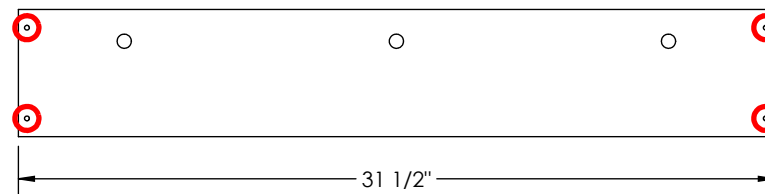

ONLY THREAD
STEMS UNTIL THE
THREADS ARE NO
LONGER VISIBLE.

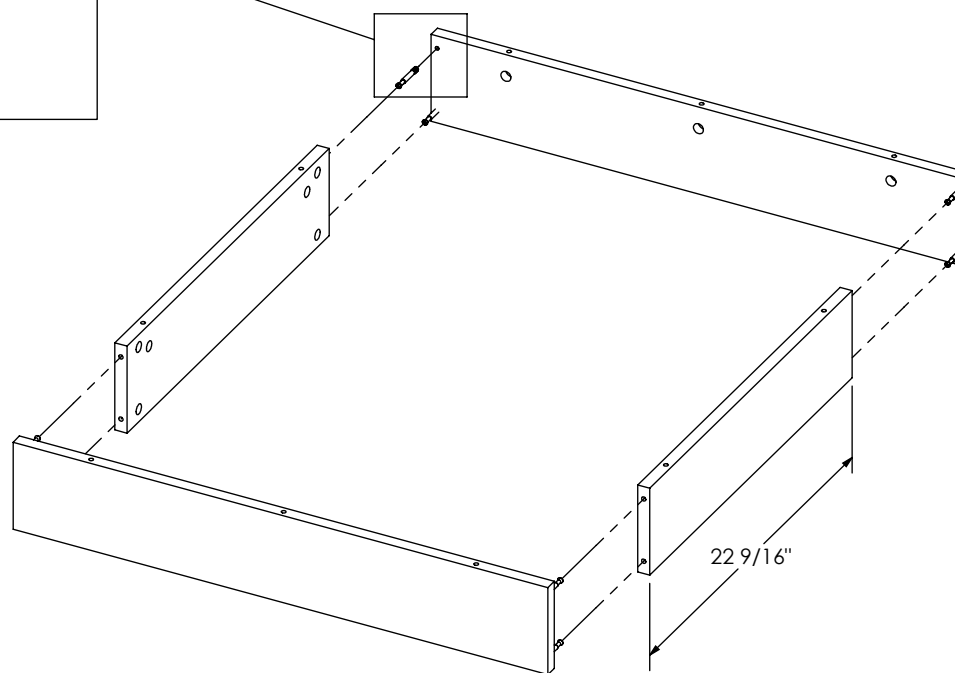

1B

- PUSH (8) OF THE CAM LOCK NUTS INTO THE LARGE CLEARANCE HOLES IN THE SHORT LENGTHS OF THE BASE AS SHOWN. THE NUT SHOULD SEAT AROUND THE STEM.

- TURN THE LOCK NUT WITH A PHILLIPS HEAD SCREW DRIVER UNTIL THE CAM LOCK NUT PULLS THE WOOD COMPONENTS TOGETHER TIGHTLY.

NOTE: REMAINING CAM LOCK STEM HOLES SHOULD ALL BE FACING UP.

HOLES FOR CAM LOCK NUTS

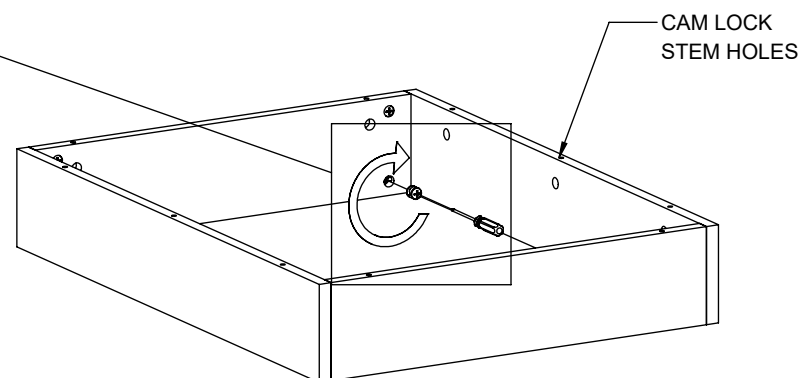
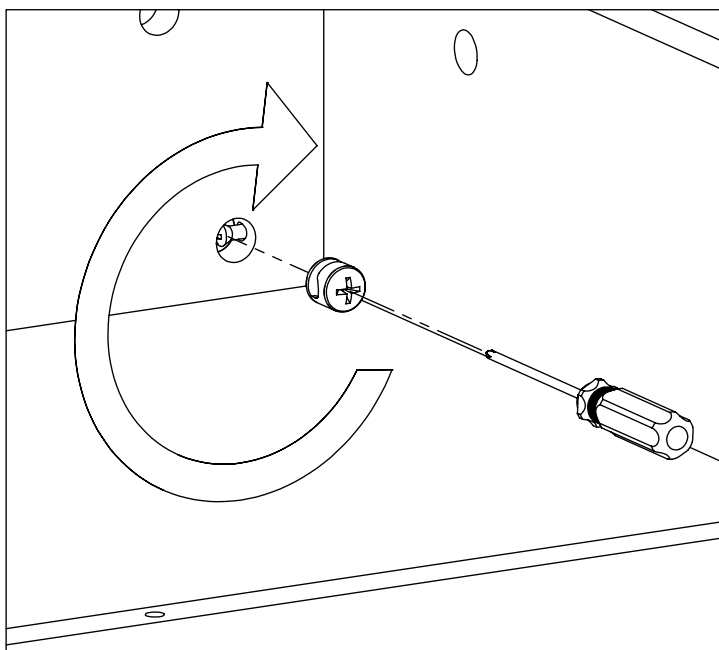
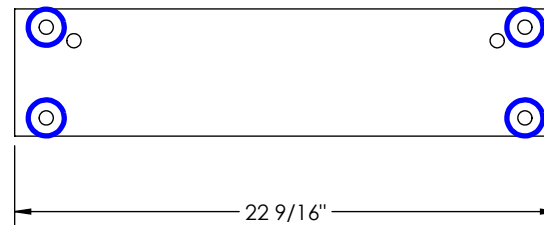

2

- SIMILARLY TO STEP 1A AND STEP 1B, THREAD THE REMAINING CAM LOCK STEMS INTO THE OVAL TOP AND SECURE TO THE ASSEMBLED TOE KICK WITH THE REMAINING CAM LOCK NUTS.

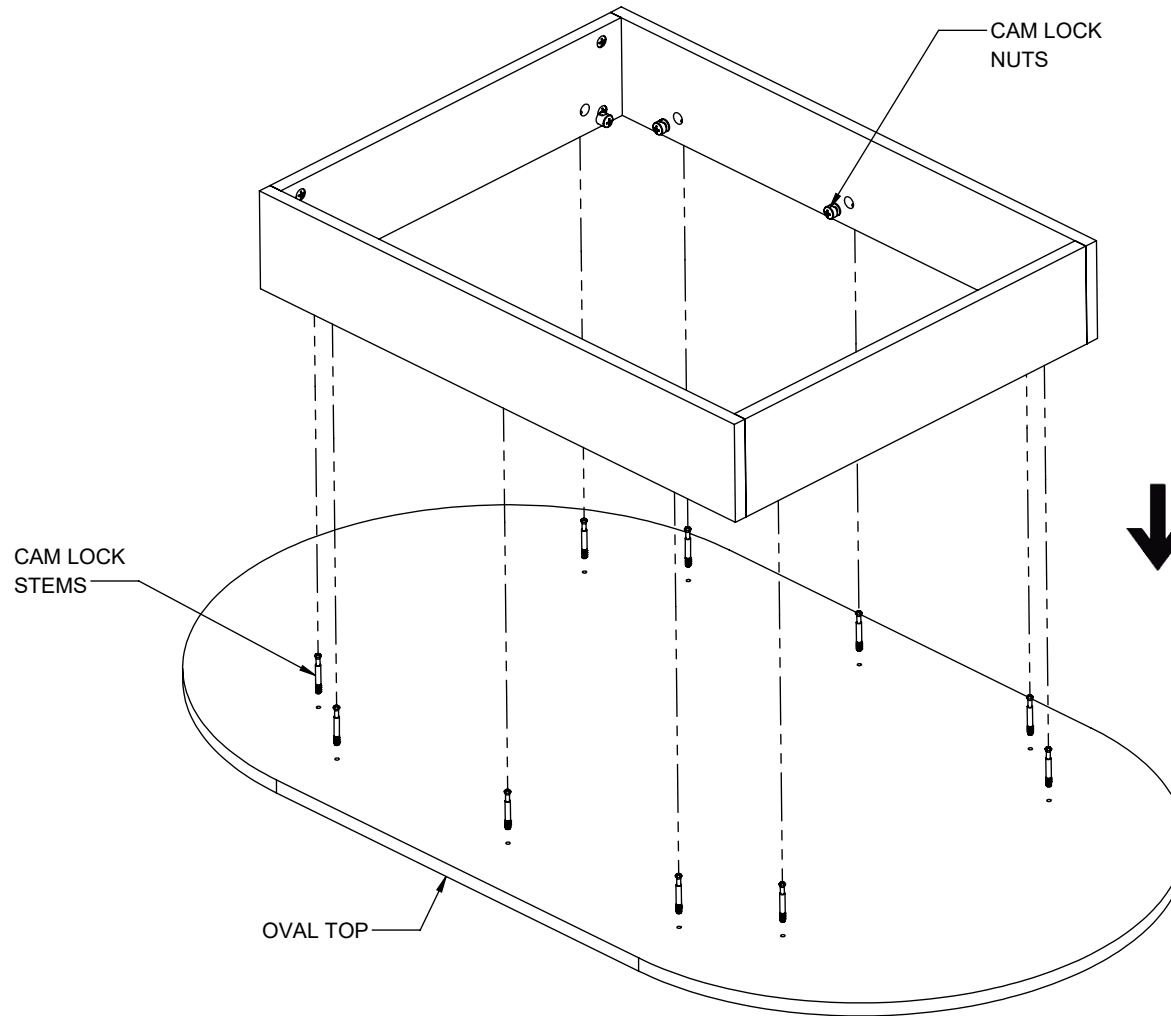

3

- ARRANGE (1) RECTANGULAR GLASS PANEL AND (6) SQUARE GLASS PANELS WITH (2) 4-WAY CONNECTORS AS SHOWN.

- GLASS PANELS SHOULD BE INSERTED INTO THE CONNECTORS AND SECURED WITH WITH THE CONNECTOR SET SCREWS.

NOTE: TIGHTEN ALL CONNECTORS TO ONE GLASS PANEL AT A TIME.

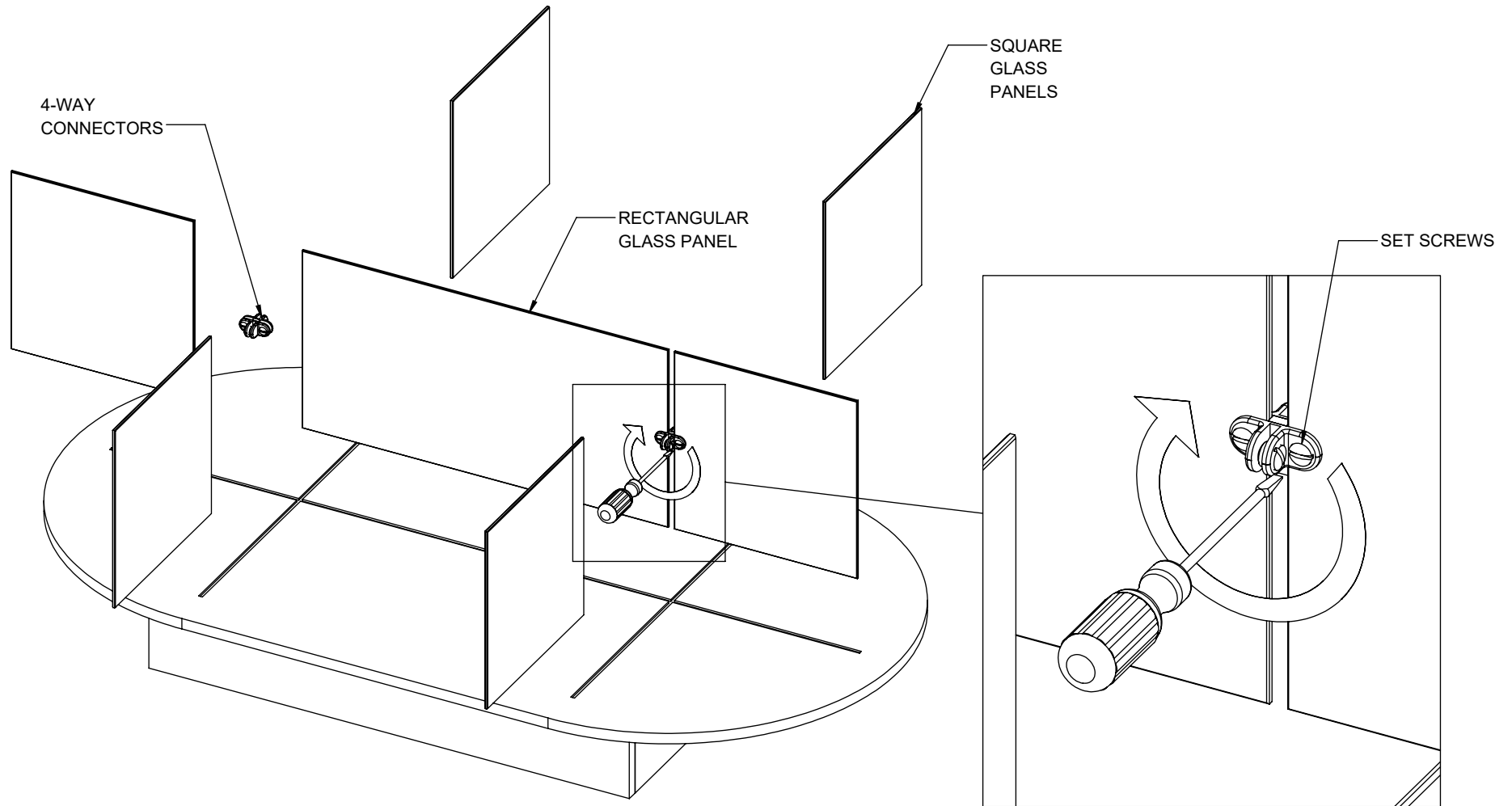

4

- SECURE (14) 4-WAY CONNECTORS ONTO THE ASSEMBLED GLASS PANELS AS SHOWN.

- SLIDE (4) QUARTER ROUND GLASS PANELS AND (2) RECTANGULAR GLASS PANELS INTO THE CONNECTORS AS SHOWN TO CREATE SHELVES.

NOTE: TIGHTEN ALL CONNECTORS TO ONE GLASS PANEL AT A TIME.

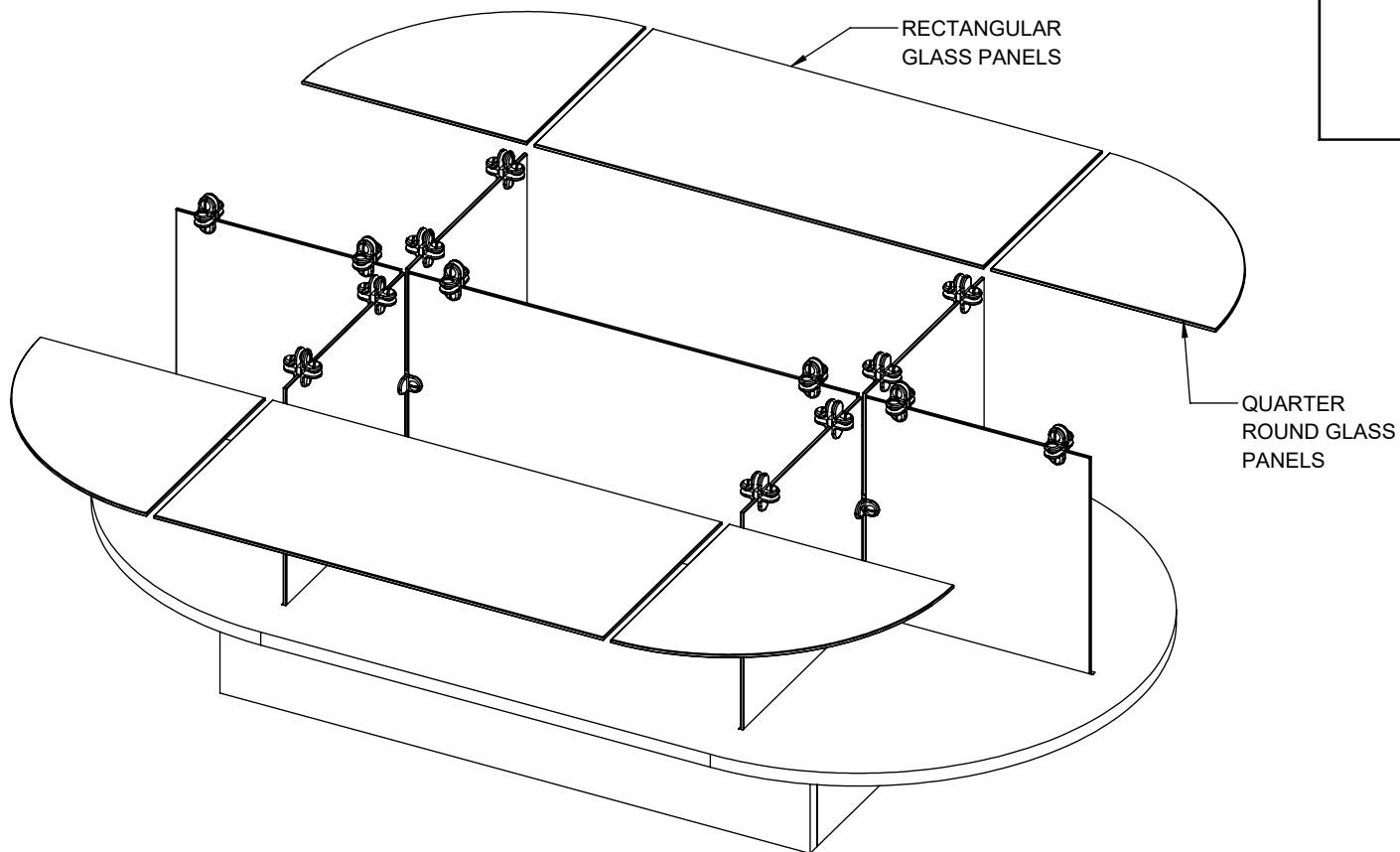
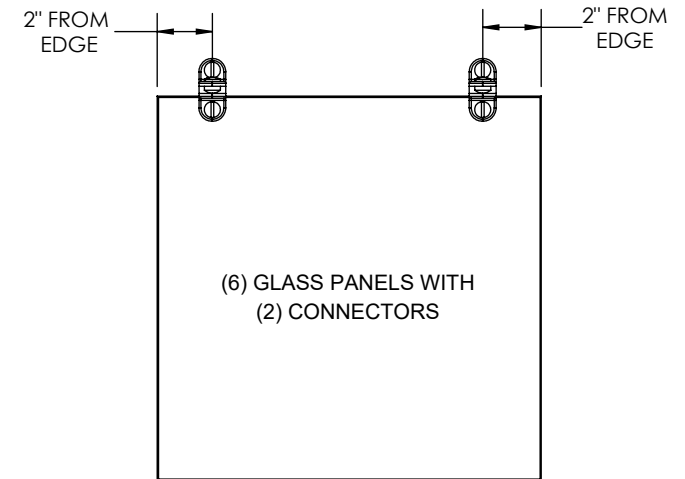

5

- REPEAT STEPS 3 AND 4 UNTIL THERE ARE (3) LEVELS OF SHELVES ASSEMBLED.

NOTE: TIGHTEN ALL CONNECTORS TO ONE GLASS PANEL AT A TIME.

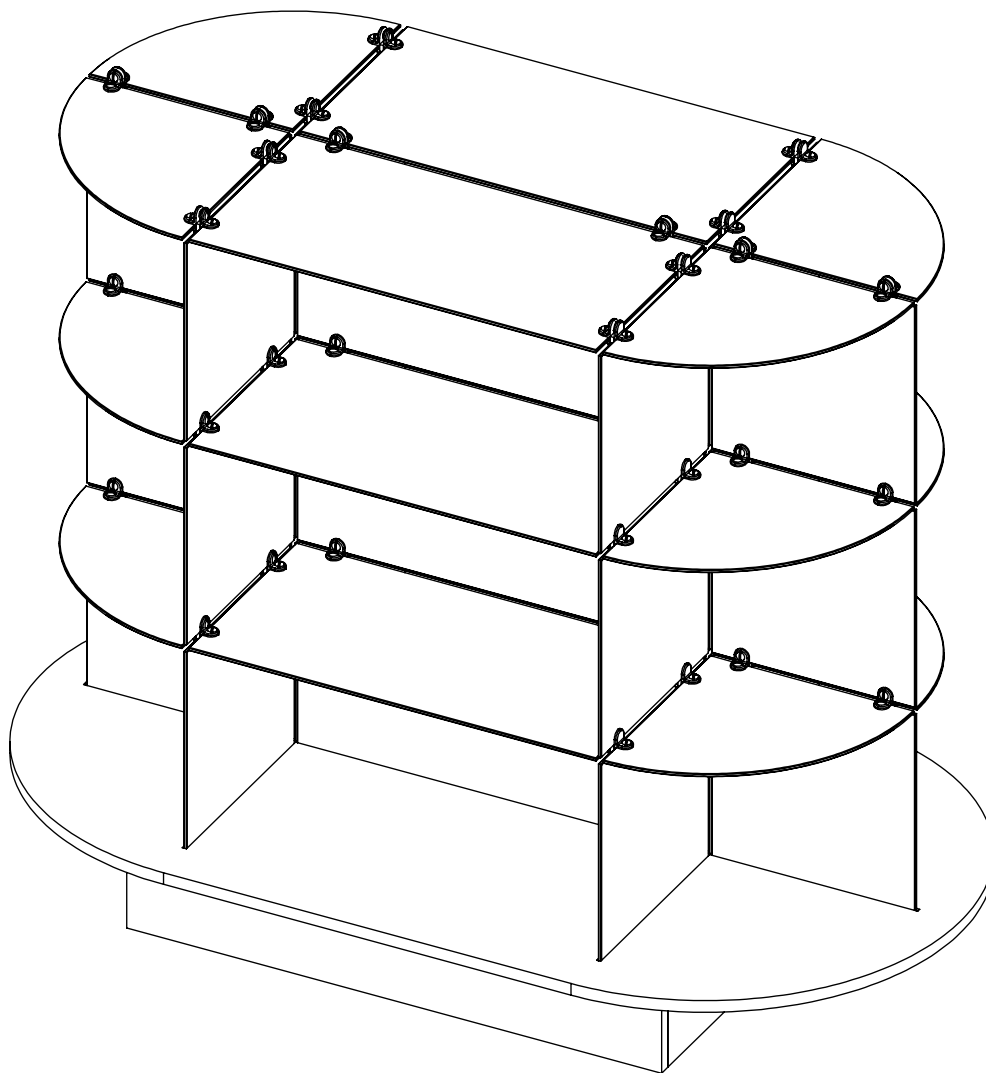

6

- USE THE REMAINING 4-WAY CONNECTORS, RECTANGULAR GLASS PANEL, AND QUARTER ROUND GLASS PANELS TO COMPLETE THE GLASS TOWER AS SHOWN.

NOTE: TIGHTEN ALL CONNECTORS TO ONE GLASS PANEL AT A TIME.

